

Valve Position Indicator, Visual LED Indication, IP68/IP66

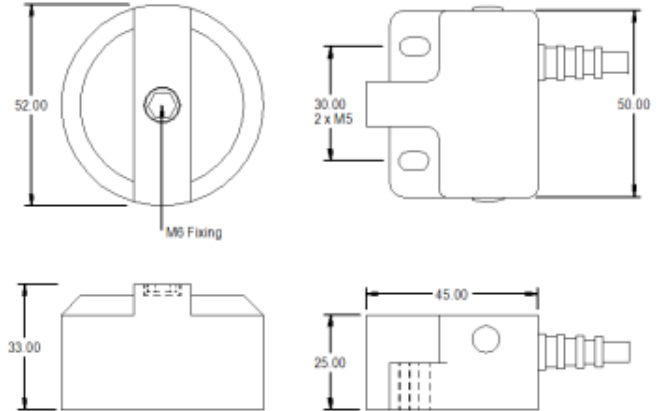

Image for Illustration Purposes Only



Physical Properties

Body Material	Engineered Resin
Connection Type	PVC Cable - 4 Core
Contacts	2 x NO / SPST
Contact Material	Rhodium or Tungsten
Dimensions	50mm x 45mm x 25mm
Visual Indicator	Rotating Puck + LEDs Open/Closed

Categories & Ratings

IP Rating	IP68 & IP66
Temperature Range	-20°C - +80°C

Electrical Characteristics

Switch	Max. Current	Max. Voltage	Current Profile	
2 x NO / SPST	1.6A	0v AC 30v DC	24 vDC	1.6A

Connection

