



Euroswitch Proximity Switch

FS-A022-W

Features:

- ATEX Exd IIC T4/T6, IP 66/67
- Zone 1, 2, 21, 22
- Back Entry Wireable Head for Direct Termination



Properties	
Housing Material	316 Stainless Steel
Body Shape	Cylindrical (wireable)
Connection Type	M20 Entry
Temperature Range	-60°C to +120°C (-76°F to +248°F)
Contact Type	SPCO/SPDT (Resistive - Volt Free Contacts)
Contact Material	Palladium Silver
Dimensions	M18 x 109mm Overall Length

Operating Characteristics	
Sensing Range	.100" (2.54mm) Ferrous Steel Target
Sensing Range with Magnet	.39" (~10mm) Magnet Dependant
Repeatability	Approx. .002" (0.05mm)
Response Time	8 milliseconds
Differential/Hysteresis	Approx. .020" (0.51 mm)

Ratings		
Supply Voltage	Maximum Switching Current	Maximum Voltage
24 VDC	3A	240 V AC/DC
110 VAC	4A	
240 VAC	2A	

Dimensions in mm

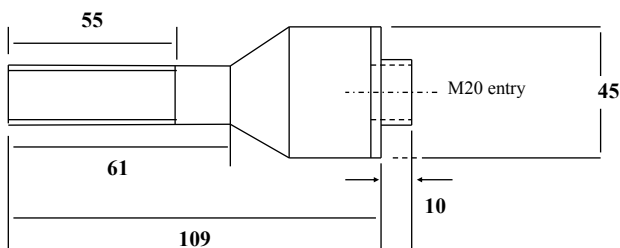

Connection Diagram

